

SJC

SCHNEIDER JAQUET

A French Manufacturing Company in Sorting, Calibrating and Sifting Solutions



CLEANERS

SNST 2150

200T/H

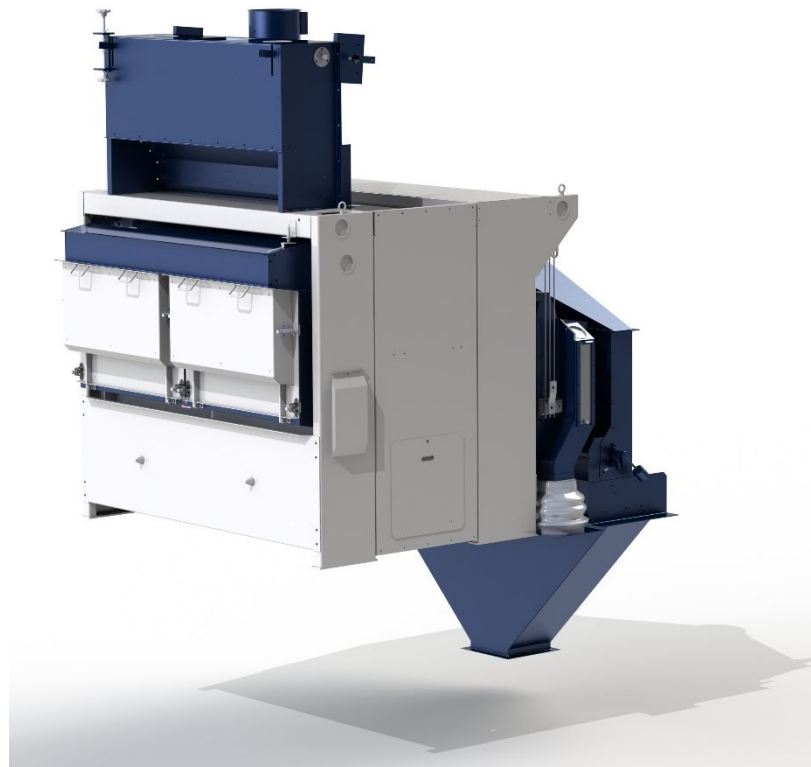

Z.I Romanerie Nord, 8 rue du Cloteau – CS 80092, 49182 Saint Barthélemy d'Anjou, France

Tél : + 33 2 41 27 35 50

Fax : 02 41 27 35 52

Mail : sjc@schneider-jaquet.fr

1 APPLICATION

The cleaner separator SNST 2150 is designed for multiple uses and meet all cleaning needs: from basic cleaning upon reception and before storing to very fine cleaning before shipment.

It has a 200T/H flow rate based on wheat, for basic cleaning but will also be adapted to all type of cleaning and all type of grains and seeds: corn, oat, soya, rapeseed, sunflower seeds...

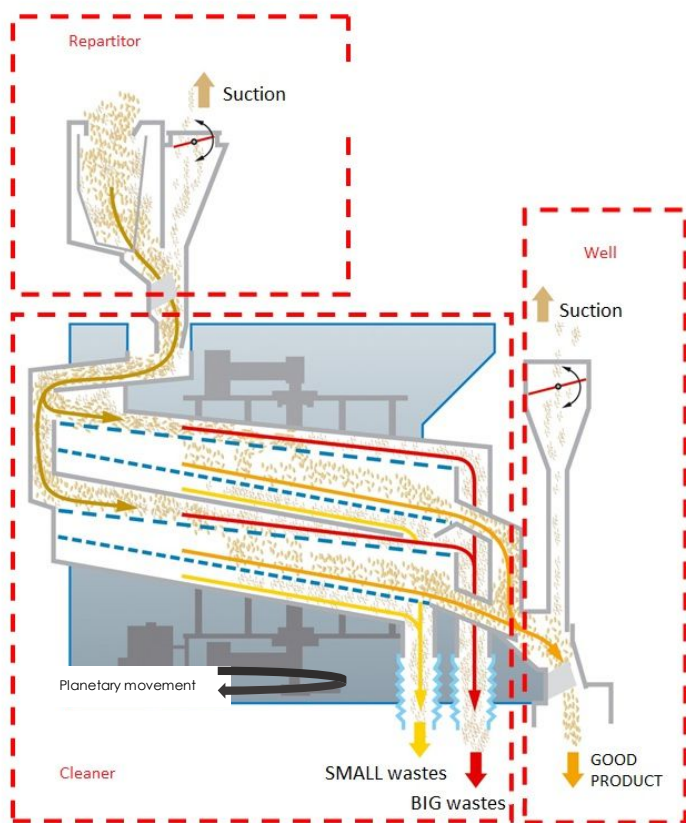

Non-contractual visual
(Depending on options)

2 OPERATION

Schneider Jaquet cleaners operate on the basis of planetary movement, recognized as allowing better distribution of grains all over the sifting surface and thus enhancing the flow rate and yield.

This type of crumbler-sifter-screener-scrubber best reconciles the most reliable methods currently available on the market for this task.

This equipment is made of a suspended box operating on the basis of planetary movement by eccentric masses, driven by a vertical shaft and a low-power consumption engine.

- 1- The grain enters in a distribution box that spread the product in slick on the complete width of the machine.
- 2- It has eight lumps breaker screens, which, by crossing of the good product, hold the big waste or the superior grades to conduct them to big waste exits.

The good product falls on eight crumbling screens that allow the separation of the small waste (crumbling) to conduct them to the crumbling exit.

- 3- The product is conducted in slick to the aspiration at the output that allows the extraction and the efficient, total and immediate recycling of the light waste: shells, hollow grains, light grains, cracks, by the crossing of air that passes counterflow through a cascade of grains.

- De-gumming balls used to unclog the screens
- Highly adaptive machine with a wide range of options

EXTRA FEATURES

- **No grains stuck in the the screens due to planetary movement.**
- **Easy maintenance.**
- **Low maintenance costs.**
- **Heavy-duty, reliable equipment.**
- **Screens can be changed quickly and easily.**
- **Compact machine.**

OPTIONS :

- Rotary feeder
- Anti-wear protection type Creusabro® or Rhino-hyde®
- Seed well
- Back chamber
- Chamber on the frame
- Common chamber on the frame
- Scrubber SEPU 200B
- Adaptable to food constraints
- Railing with scale

3 TECHNICAL CHARACTERISTICS

Model	Flow rate (tph)*	Surface area of screens (sqm)	Dimensions** (mm)			Weight** (kg)	Power (kW)
			Length	Width	Height		
SNST 2150	200	16	3 017	2 568	3 072	3 200	3

*Flow rate: basic cleaning for wheat Bulk density 0.75, humidity 14%, with 6% of impurities

**Weights and dimensions for standard machines